

# SENSORY MAP

This Sensory Map is designed to help you prepare for your visit to the museum. It indicates average sound and light levels, highlights busier spaces, and areas with seating.







The galleries are often quiet. Noise and crowding in each space depends on other visitors and daily events such as tours and school visits.

Chiming clocks, creaky floorboards, people talking and a quiet hum of air conditioning are regularly occurring sounds in the galleries. The Restaurant and Café are the loudest spaces, with the noise of people talking, of crockery and cutlery, and of coffee machines.

The Housekeeper's Room has changing displays. The light levels in this room often change, depending on the display.

The galleries are temperature controlled so not usually very hot or very cold.

If you need assistance, ask a member of staff and they will help you find your way.

	<b>Quieter Space</b>	Spaces with lower noise levels on average
	<b>Noisy Space</b>	Spaces with higher noise levels on average
	<b>Busy Areas</b>	Areas that are busier on average
	<b>Seating</b>	Rooms with seating for visitors. Portable folding stools are also available.
	<b>Brighter Light</b>	Brighter spaces with more artificial and/or natural light
	<b>Daylight</b>	Light in these spaces is more affected by time of day and weather
	<b>Lower Light</b>	Darker spaces created by lower lighting

# GROUND FLOOR



Busy Areas



Seating



Noisy Space



Quieter Space



Brighter Light



Daylight



Lower Light

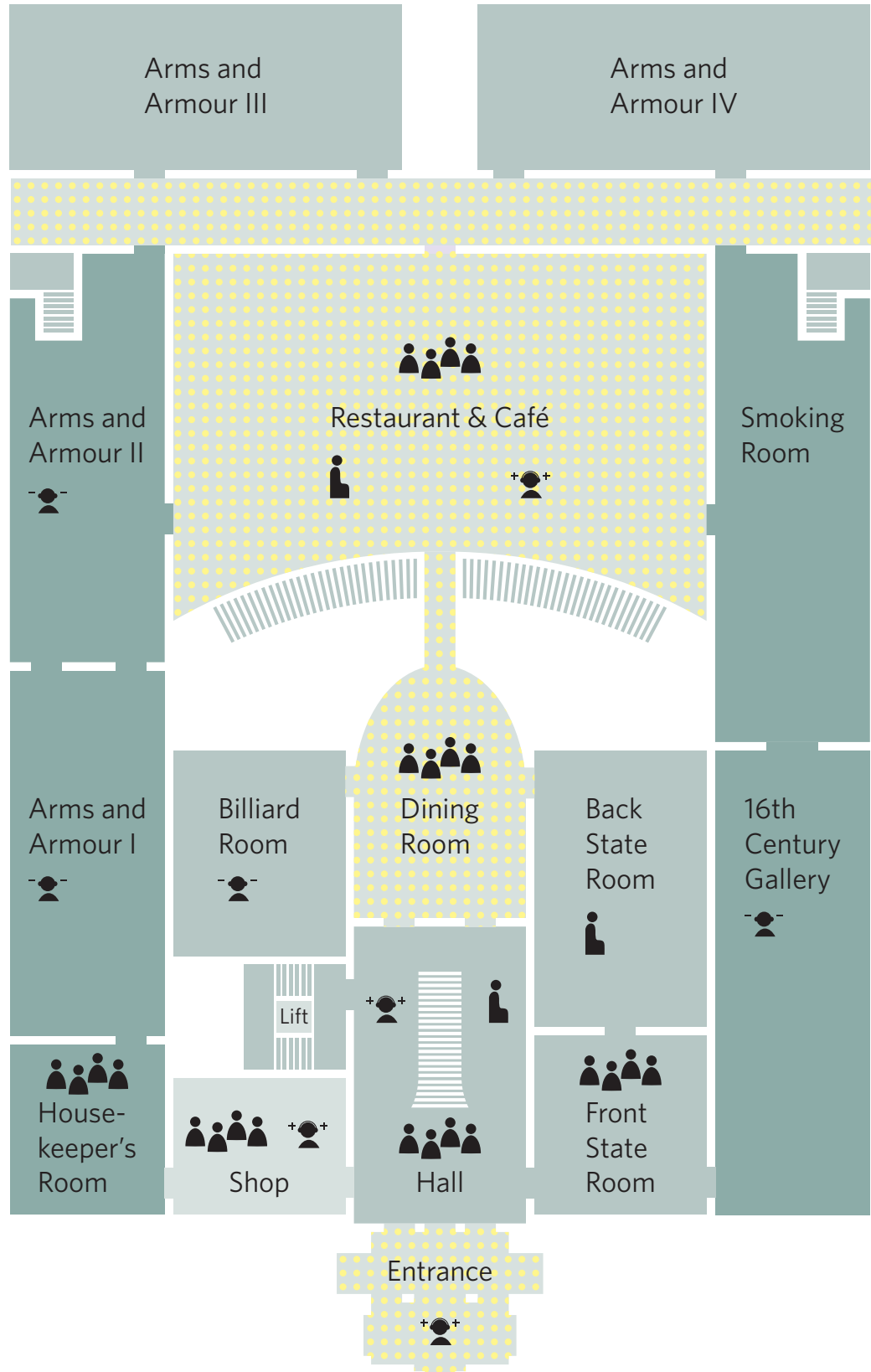

# FIRST FLOOR



Busy Areas



Seating



Noisy Space



Quieter Space



Brighter Light



Daylight



Lower Light

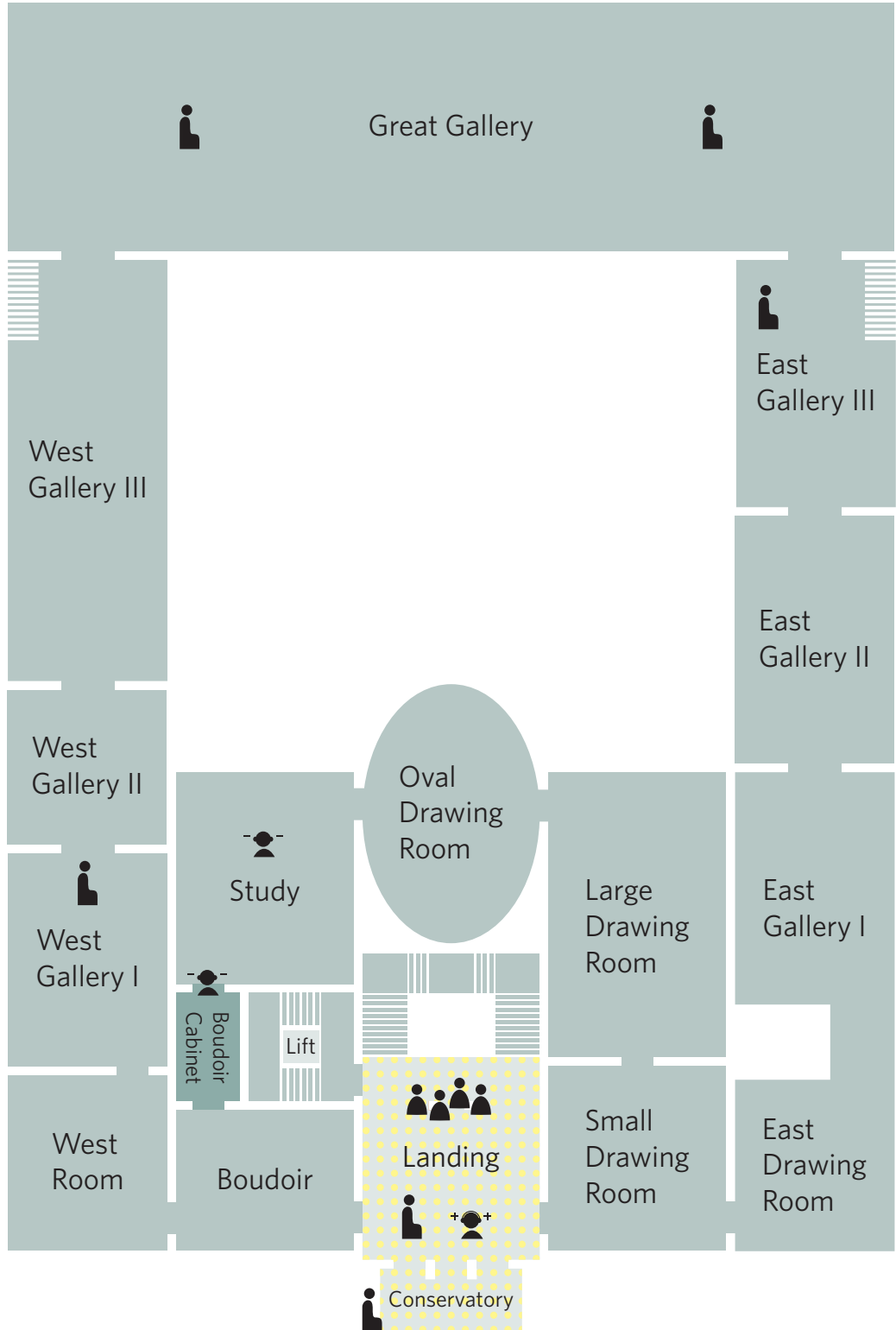

# LOWER GROUND FLOOR



Busy Areas



Seating



Noisy Space



Quieter Space



Brighter Light



Daylight



Lower Light

